

DELTRONIC

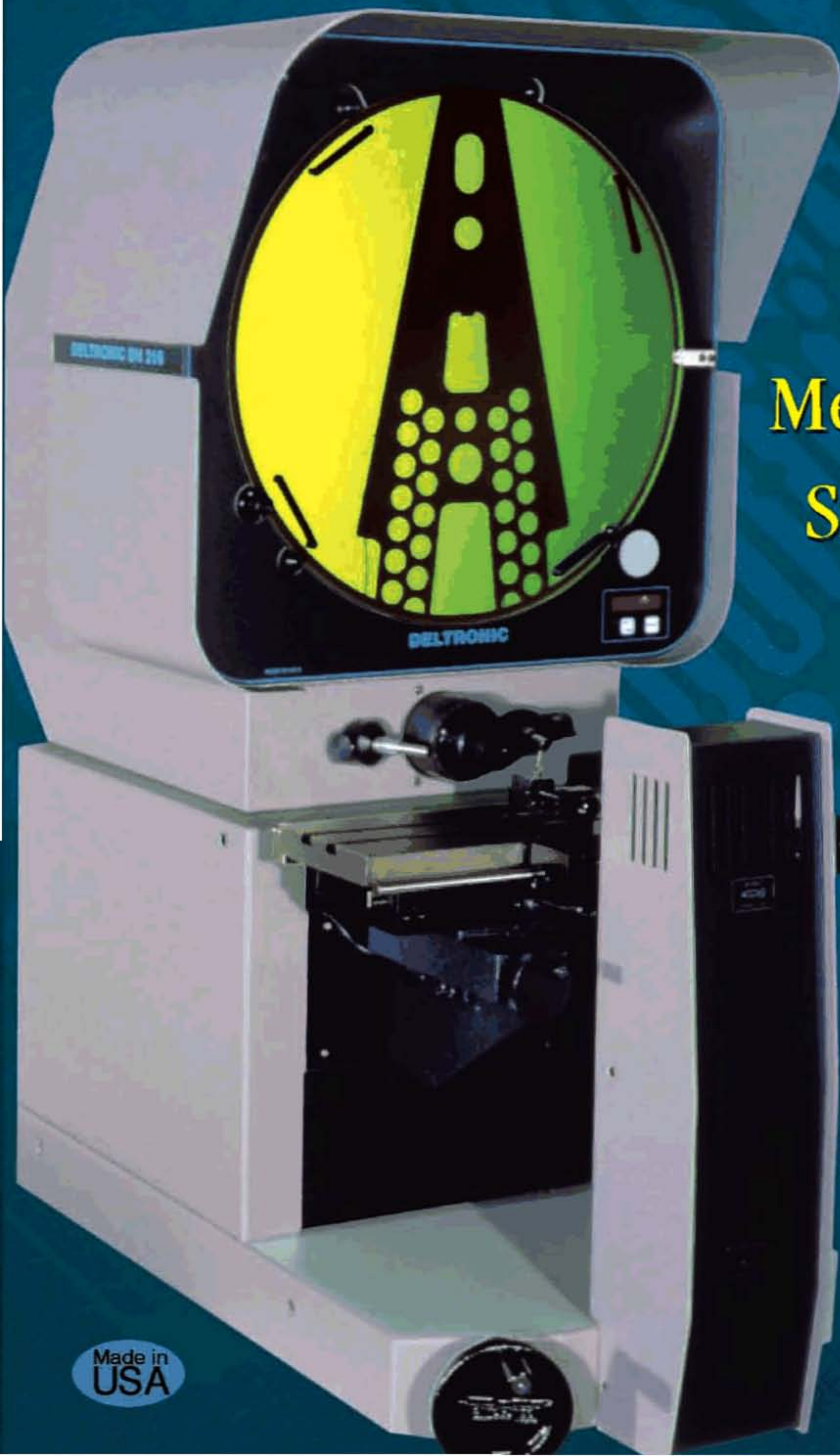

Quality
Measurement
Since 1955

DH216
Horizontal
Optical
Comparator
System

Made in
USA

When you think of accurate measurement, think of DELTRONIC. As a leader and innovator in high-accuracy products for over forty years, we have been designing and manufacturing systems and solutions for thousands of applications on a worldwide basis. We feel our success was achieved because our goal has always been to deliver quality products backed by excellent service at fair prices. It always will be.

DH216 16" Horizontal Bench-Top Comparator System

Standard Features

- *Hi / Low Enhanced 150 watt Illumination System*
- *Full Usable 16" Viewing Screen*
- *10" X axis and 6" Y axis Stage Travel*
- *Cross Roller Bearings*
- *Built-in Helix Stage*
- *Quick Release "X" Travel*
- *Sturdy All-Metal Design*
- *Erect Optical Image*
- *Bayonet Lens Mount*
- *Easy-View Vertical Screen*
- *Electronic Screen Protractor (ESP)*
- *Rotating Chart Clips*



Electronic Screen Protractor (ESP)

Reads angles directly and will display angles to either a minute or 0.01 of a degree on an LED readout. ESP indicates angles from zero in either direction in both INCREMENTAL and ABSOLUTE modes. A standard feature.



Quick Change Bayonet Lens Mount
Provides for instantaneous magnification lens change without calibration. A standard feature.



±15° Helix Stage
For thread-form measurement with vernier graduations in 5' increments. A standard feature.

Electronic Measuring Systems



Basic Digital Readout

612R

Standard Features

- 2 Axis Readout
- 3 Point Radius
- Polar Coordinates
- 9 Point Store and Recall
- Datum Reference
- Inch/Metric
- Preset

Options

- Automatic Edge Sensing



Standard Digital Readout

MPC-5

Standard Features

- 2 Axis Readout
- Alpha Display for Prompts
- 30 Point, Multi-Point Functions
- Radius, Angle, Line, Point, Skew, Scan and Datum Reference
- Inch, Metric, Polar, Preset, Centerline Complement
- 100 Store and Recall Point

Options

- 3 Axis Readout
- Programmable Footswitch
- Programmable Remote Keypad
- SPC Output
- Automate Measurement System (AMS)
- Automatic Edge Sensing



Deluxe Measurement Software

MPC-6

Standard Features

- 2 Axis Readout
- Message Window
- 30 Point, Multi-Point Functions
- Includes CAD/CAM
- Storage Window
- Radius, Angle, Line, Point, Skew, Scan, and Datum Reference
- Inch, Metric, Polar, Preset, Centerline Complement
- Includes G D & T

Options

- 3 Axis Readout
- SPC Output
- Automate Measurement System (AMS)
- Automatic Edge Sensing

Available Options

- Automated Measurement System (AMS), gives you automatic inspection
- Motorized Focus Axis
- Swing-Clear Lamphouse for Surface Measurement of Large Parts
- Motorized stage with joystick control
- Fiber-Optic Illumination for Surface Measurement
- Extended 12" X Axis Stage Travel
- Automatic Edge Sensing
- Comparator Cabinet

SPECIFICATIONS

Standard Features DH216

1. Fully usable 16" (405mm) viewing screen with edge-to-edge accuracy of 0.05%, 17.5" (445mm) glass screen
2. 10" X axis (254mm) and 6" Y axis (152mm) stage travel
3. Heat-treated nickel plated stage surface
4. Screen-locking mechanism
5. Digital Electronic Screen Protractor (ESP) with INC/ABS switchable displays 1' or .01°
6. Quick-change bayonet Lens Mount, no calibration needed
7. Vertical screen for easy viewing
8. Rotating Chart Clip System mounted on screen
9. Quick-release X axis clutch for rapid stage movement, with infinite fine adjustment
10. Erect image
11. ±15° Helix stage, 5' readout increment
12. Telecentric Lens System
13. 150 watt Profile Illumination System with hi / low intensities

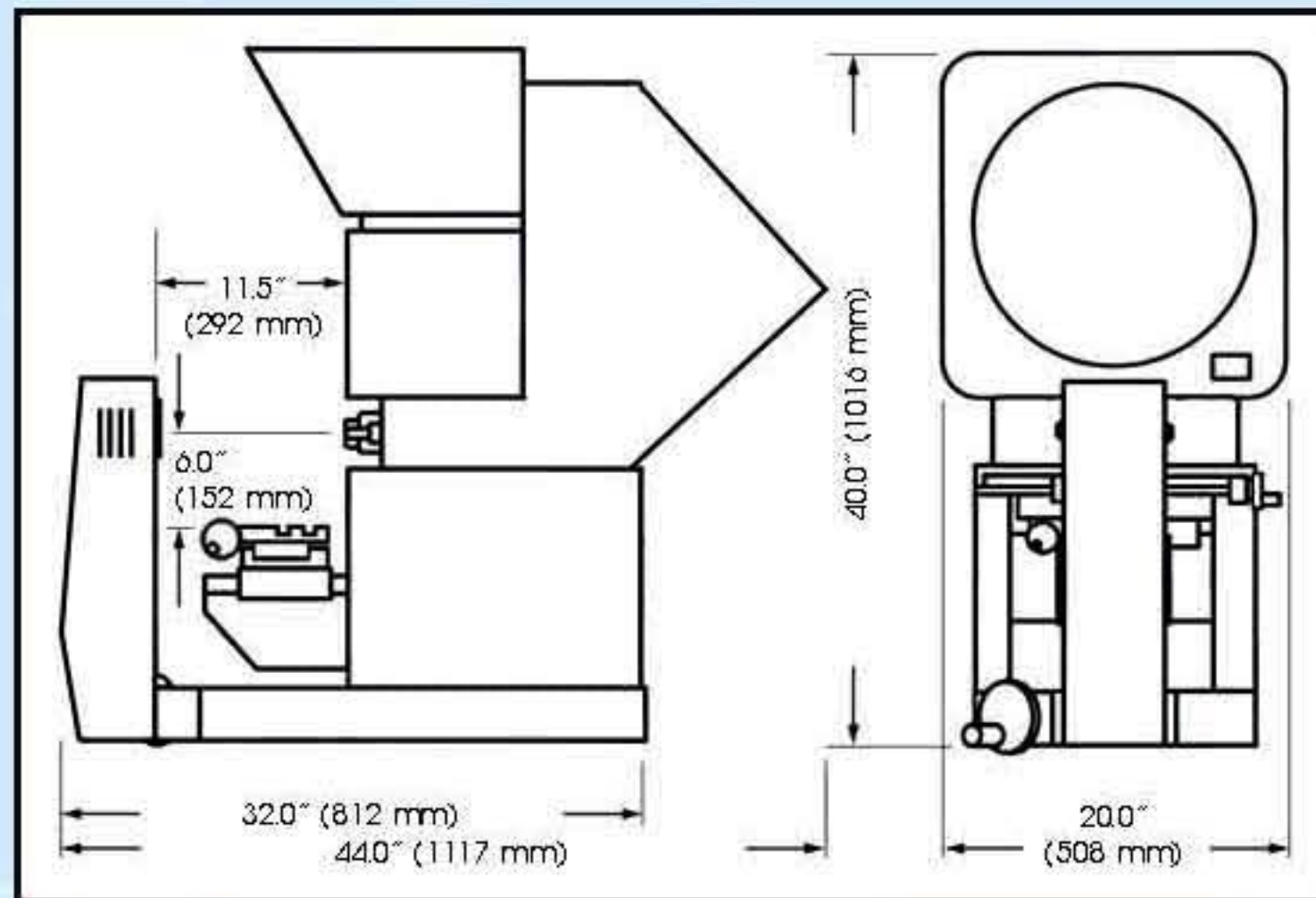

Screen

17.5" (445mm) diameter glass screen
60° and 90° crossed lines
1' or 0.01° digital display

Magnification Lenses

10x, 20x, 25x, 31.25x, 50x, 100x

Magnification Accuracy

±0.05% contour
±0.10% surface

Profile Illumination

Tungsten-Halogen bulb, 24 Volt, 150 Watt
Blower cooled

Surface Illumination

Tungsten-Halogen bulb, 24 Volt, 250 Watt
Fiber-Optic Delivery
Blower cooled

Work Stage

Standard

Travel X-axis 10" (254mm) and Y-axis 5" (127mm)
Surface Electroless Nickel Plated Steel; 15" (381mm) by 5" (127mm) with two dovetails.
Focus Travel 2.3" (58mm)

Option 1. Extended 12" X-axis Travel

Travel X-axis 12" (304mm) and Y-axis 5" (127mm)
Surface Electroless Nickel Plated Steel; 18" (457mm) by 5" (127mm) with two dovetails.

Option 2. Extended 18" X-axis Travel

Travel X-axis 18" (457mm) and Y-axis 5" (127mm)
Surface Hard Anodized Alum; 23" (584mm) by 5" (127mm) with two dovetails.

Option 3. Motorized X&Y Axis with Joystick

Option 4. Motorized Focus Axis

Option 5. Automated Measurement System - AMS

Lens Specification

- True Telecentric Design - total image stability.
- Magnesium fluoride coated for high performance lens transmission and contrast.
- Spherical aberration correction.
- Optional green filter is recommended for all magnifications other than 100x.

	10x	20x	25x	31.25x	50x	100x
Field of View (largest diameter on screen)	1.60" 40.64mm	.80" 20.32mm	.64" 16.26mm	.512" 12.95mm	.32" 8.13mm	.16" 4.06mm
Working clearance lens to work piece	3.15" 80.00mm	3.23" 82.04mm	2.75" 69.85mm	2.20" 55.88mm	2.00" 50.80mm	1.69" 42.93mm

Electrical

115/230 Volts ~
50/60 Hz (24 Volts to all lamps)

Machine Weight

Net approximately 300 pounds,
shipping weight approximately 450
pounds. **CE** Approved